

The logo for UNKA SOUND SYSTEMS is centered on a dark, textured background. It features a stylized 'U' and 'K' on the left, followed by the word 'UNKA' in a bold, italicized, outlined font. Below 'UNKA' is the phrase 'SOUND SYSTEMS' in a smaller, italicized, outlined font. A red brushstroke underline is positioned below the text.

**UNKA**  
*SOUND SYSTEMS*

Unique Audio Solutions



FORCE <sup>TM</sup> K

FORCE IK2A is an active satellite speaker of long throw and high performance, designed for middle and big-size venues. It combines one 12" speaker with three 1,75" high frequency drivers mounted on wave-guides.

Class-D amplification and our DSP are guarantee of exceptional quality of the sound and power performance.

#### PRODUCT DESCRIPTION:

Our big size venues active speaker FORCE IK2A has very high size/power ratio. It is made of 15mm birch plywood, strong structure and low weight, considering its power for 28kg.

It uses Class-D amplification and our DSP with 4 different presets.

It's easy to use and optimized to be utilized in conjunction with our MAKS, FORCE S, FORCE X series subwoofers forming powerful PA systems for middle and big size venues.

- Class D amplification.
- 24-bit DSP with 4 presets.
- European Neodymium transducers.
- 15 mm Birch plywood.
- Neutrik connectors.
- Finished in polyurea paint.
- Horizontal and vertical pole mounting.

Optimization of our systems.

We have created several possibilities to mount our systems, according to the needs of our clients.

We are aware that we have clients who need absolute control over the system, and clients who do not need this type of technology.

For this reason we have decided to create the FORCE LH102 systems, taking into account that their internal components are always the same, the only difference is power and control.

New addition of the new processor with FIR filters.

It has a 2x1,100w power module, one channel to power the 12" 1,000w rms speaker and the other to power the treble.

External control through RJ45 and with 4 presets, makes it an easy system to manage and maximum control.

**FORCE IK2A**

# TECHNICAL SPECIFICATIONS FORCE IK2A

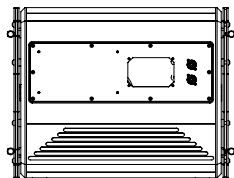
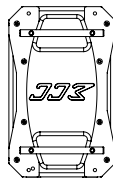
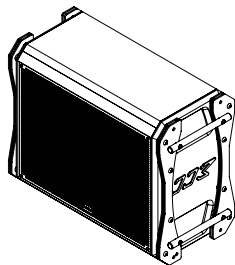
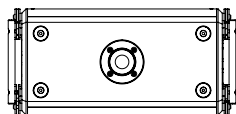
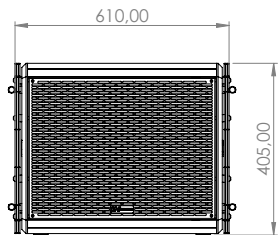
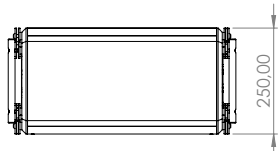

## COLORS & PREMIUM FINISHES



Black



White



Custom

## ACOUSTICS

POWER HANDLING	1 x 1.000 W @ 8 Ω + 3x 60 W @ 16 Ω
MAX POWER	2.000W + 360W Program
IMPEDANCE	1 x 8 Ω 3 x 16 Ω
COVERAGE	HORIZONTAL 140° / VERTICAL 15°
FREQUENCY RANGE	80 Hz - 20 kHz +/- 3dB
SPL 1W/1MT	1x 96 dB 3x 109 dB
MAXIMUM SPL	142 dB CONTINUOUS

## CROSS OVER

TYPE	DSP CONTROLLED PRESET SPEAKERS
FREQUENCY	100Hz

## TRANSDUCERS

	1 X 12" NEODIMIO + 3 x 1,75" NEODIMIO
--	---------------------------------------

## AUDIO INPUT

CONNECTORS	MALE + FEMALE PARALLEL 3 POLES BALANCED XLR
WIRING	PIN1 = GROUND / PIN2 = HOT / PIN3 = COLD

## AUDIO OUTPUT

CONNECTOR	MALE + FEMALE PARALLEL 3 POLES BALANCED XLR
-----------	---

## POWER INPUT

CONNECTOR	1 X POWERCON IN 1x POWERCON LINK
-----------	----------------------------------

## AMPLIFIERS

TYPE	1 MODULES CLASS D - DSP CONTROLLED
SUBWOOFER POWER	2 x 1.100 WATT @ 8 Ω
PROTECTIONS	DYNAMIC LIMITER, OVER CURRENT, OVER TEMP, SHORT CIRCUITS

## AC POWER

OPERATING RANGE	STANDARD 90 - 265 Vac 50Hz (STANDARD)
MAX CONTINUOUS AND BURST CURRENT	STANDARD 2A (>10SEC)

## PHYSICAL

MEASURES	610 x 405 x 250 mm (24,02 x 15,94 x 9,84 in)
WEIGHT	28 kg (61,73 lb)